

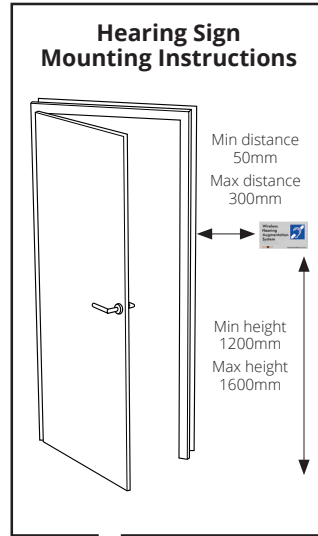

FOR LEARNING SPACES UP TO 100M² Agile Hearing Augmentation

Suggested Specification Wording Hear and Learn UConnect Mini

- A. Unobscured and in line of sight, in-wall cavity installation of the bespoke Hear and Learn UConnect Mini interface with the TransmitterTray and SecureSlide. Electronics and power supplies are contained inside Hear and Learn UConnect Mini with no visible cabling or GPOs.
- B. Communal transmitter bundles and bespoke instruction documents supplied by Hear and Learn for ownership and maintenance by the School.
- C. TransmitterTray on Hear and Learn UConnect Mini is used to connect any and all transmitters relevant to different brands and types of hearing aid receivers worn by all students, teachers and visitors provided by Government or privately procured.
- D. HearAssist Commissioning and staff training with associated telephone, email and video conferencing and support provided by Hear and Learn.
- E. Connectivity to transmitters of screen audio, PA office messaging and other forms of audio to achieve augmentation required by BCC, Disability Law and associated Standards as described hearandlearn.com.au/wp-content/uploads/pdf/Hear-and-Learn-Install-Guide-For-Uconnect-Mini.pdf and at hearandlearn.com.au/install 'INSTALLATION INSTRUCTIONS FOR UCONNECT MINI STEEL'
- F. Compulsory braille tactile signage supplied by Hear and Learn.

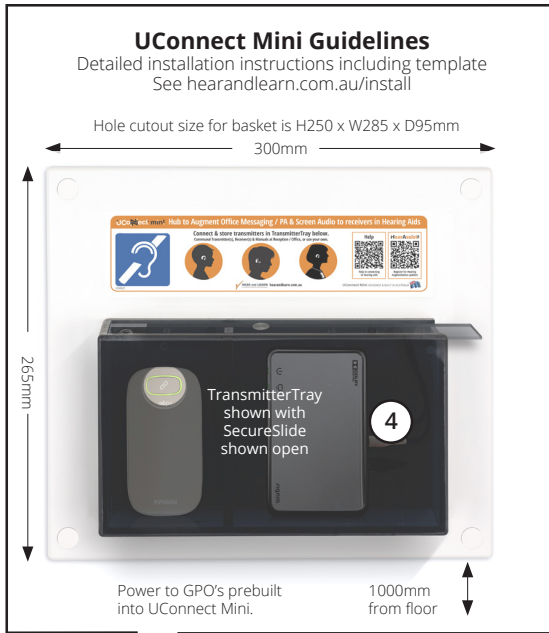

- 1 **UConnect Mini**
Power to GPO's prebuilt into wall recessed UConnect Mini.
- 2 **TV/Screen/Projector**
SoundHouse captures and distributes TV/Screen/Projector UConnect Mini can receive audio from TV/ screen/projector for augmentation to receivers in aids. If length of cable from output of TV/Screen/Projector to UConnect Mini is more than 10 metres, use CAT 5E/6 cable with 3.5mm Stereo Audio Cat5e/6 Extenders at each end for connection to UConnect Mini (via 3.5 mm male plug) and to TV/Screen/Projector (to suit output of device).
- 3 **PA Speaker**
From closest PA speaker, cable from rear of the speaker to the terminal in SoundHouse. SoundHouse transforms signal internally – no additional transformer required.
- 4 **TransmitterTray with SecureSlide**
TransmitterTray houses various transmitters to receivers in hearing aids supplied to Australian learners. SecureSlide allows for full security of transmitters and ligature-free usage.
- 5 **HearAssist**
Provided by Jim Russell of Hear Room to ensure effective installation, staff training, ongoing support, online and telephone support.

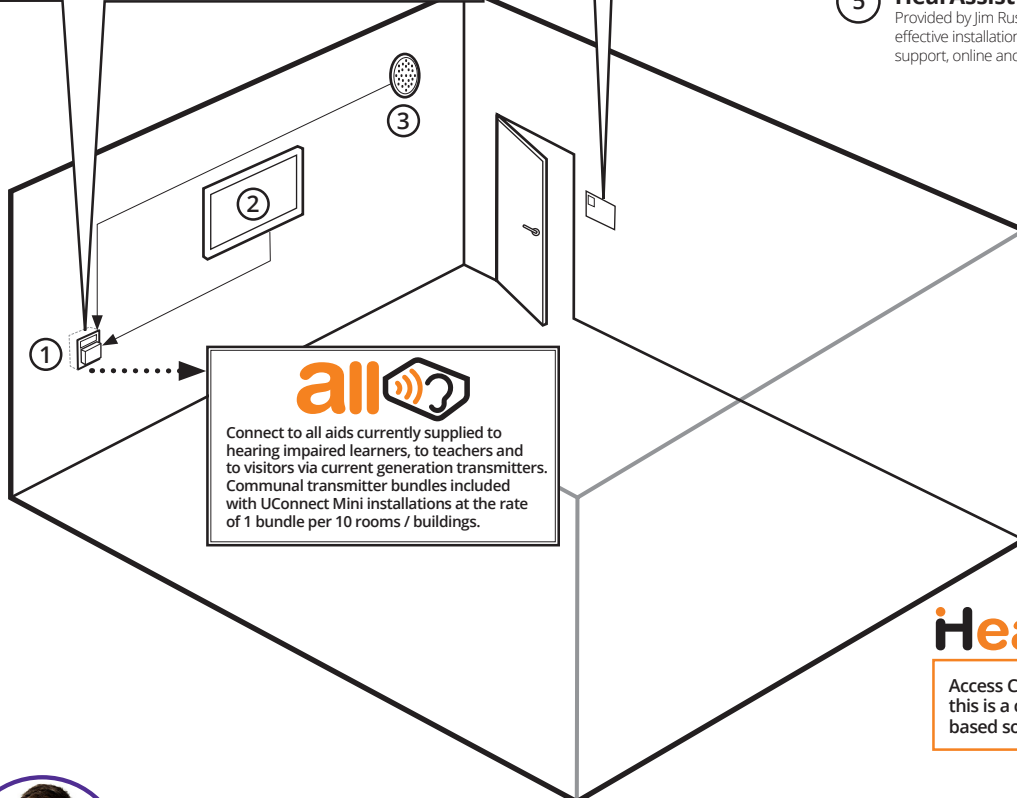

Access Consultant report advising this is a certifiable performance based solution available on request



Endorsed and supported with HearAssist by Jim Russell of Hear Room

Jim Russell Director Principal Consultant Hear Room
0424 077 995 | Jim.Russell@hearroom.net